

SERIE 100 Silent

SERIES 100 Silent



Sistemi scorrevoli per porte / Sliding systems for interior doors

Sistemi scorrevoli per porte / Sliding systems for interior doors

KIT 0138 P - MAX 120 KG

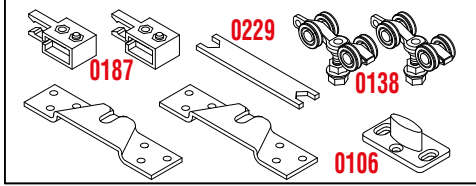

Legenda KIT / Kit Legend

0138	Carrello con 4 cuscinetti <i>Truck with 4 ball-bearings</i>
0187	Fermo superiore regolabile <i>Adjustable upper stopper</i>
0106	Guida inferiore <i>Lower guide</i>
0229	Chiave di regolazione <i>Adjusting spanner</i>

Legenda altri componenti Legend other items

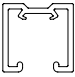
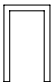
0196		Profilo alluminio superiore <i>Upper aluminium profile</i>
0251		Profilo alluminio inferiore <i>Lower aluminium profile</i>

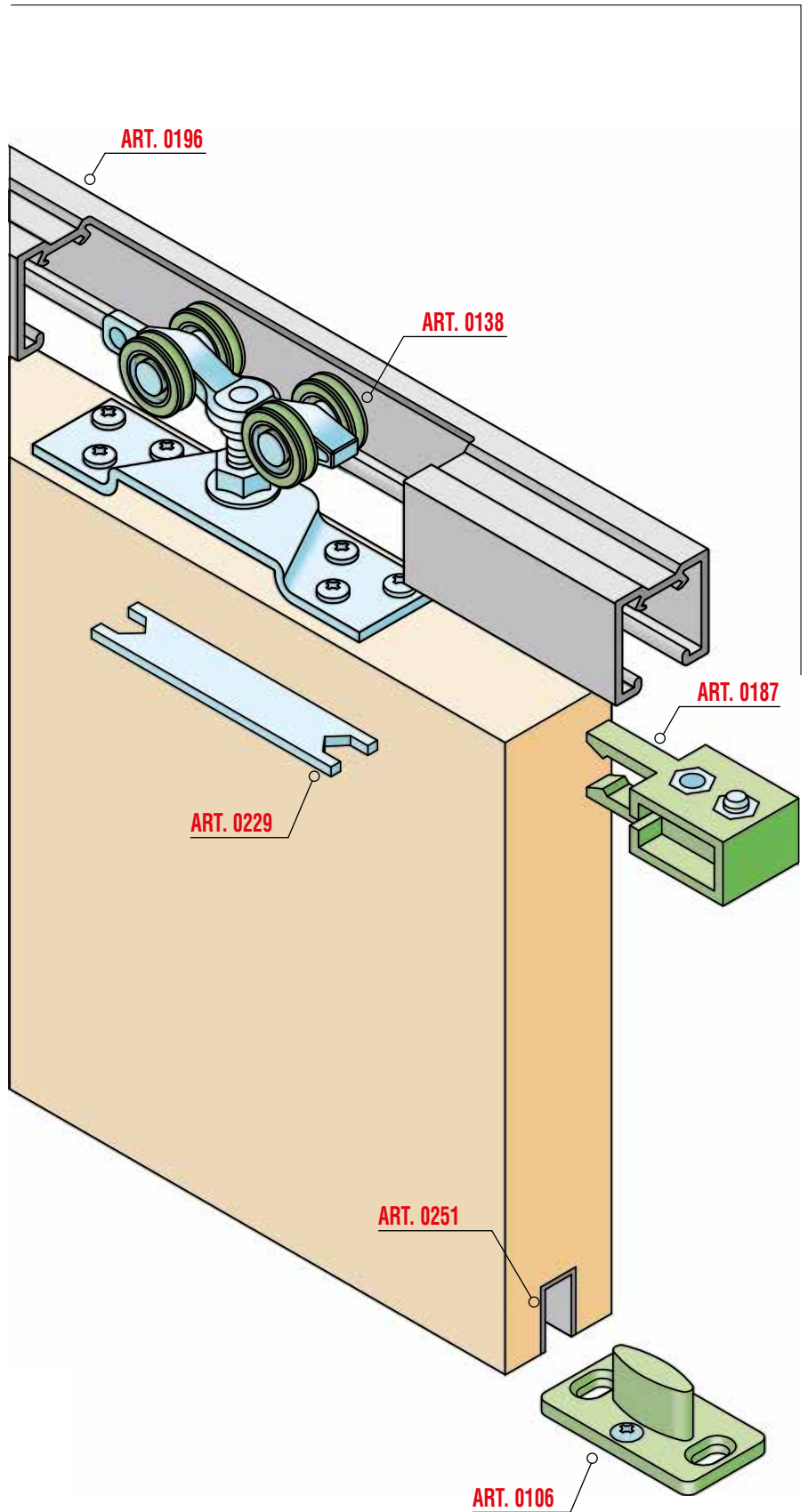



Sezione verticale / Vertical section

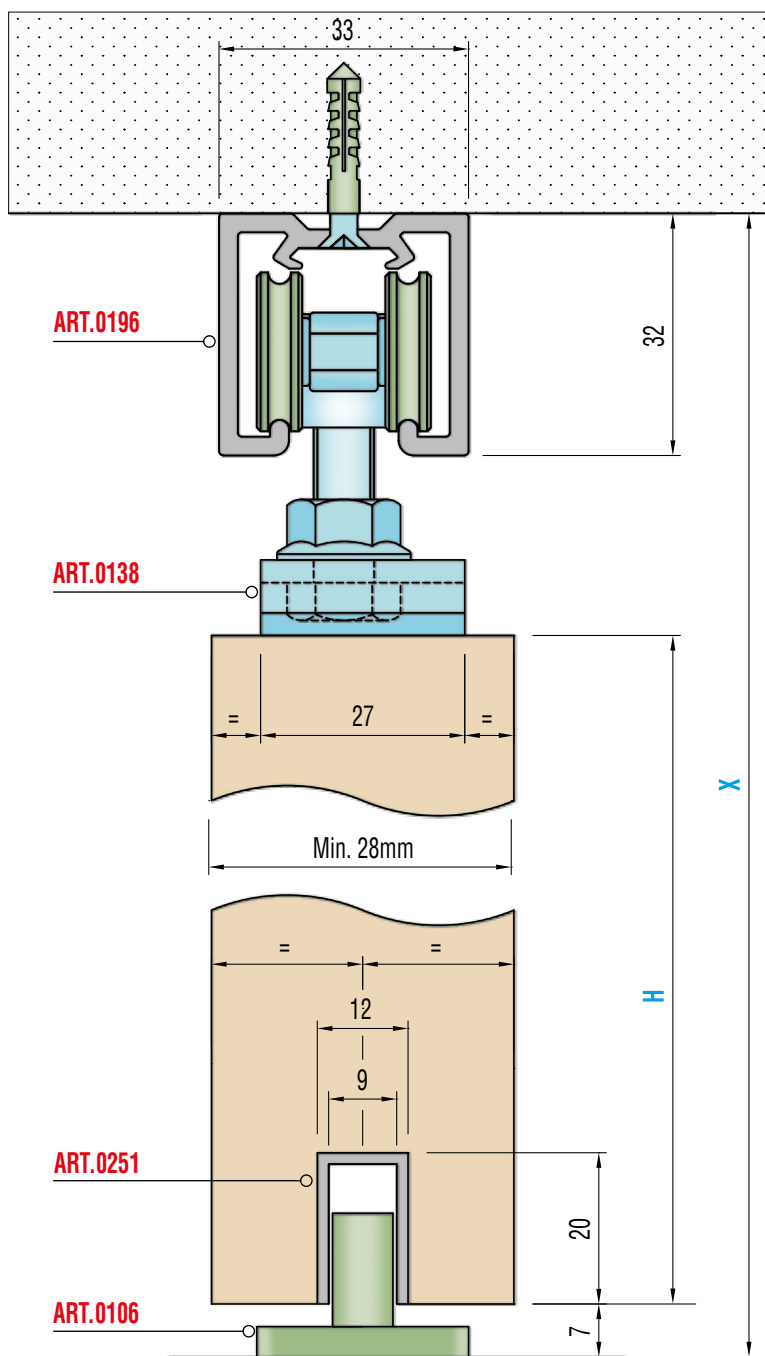

Peso massimo anta Kg. 120
Maximum door weight Kg 120

H = X - 63

Dimensioni standard / Standard dimensions

A	B
larghezza porta - length of the door	lunghezza binario - length of the track
500-700 mm.	1100 mm.
710-900 mm.	1500 mm.
900-1000 mm.	1700 mm.
910-1200 mm.	1900 mm.

B = LUNGHEZZA BINARIO - LENGTH OF THE TRACK

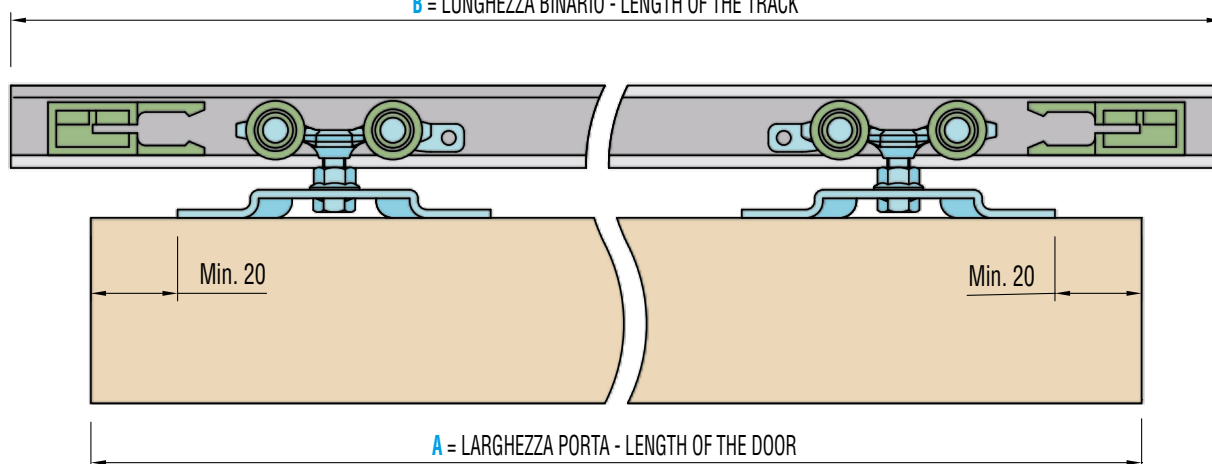



Schema di montaggio / Assembling

IL SISTEMA PERMETTE LA REGOLAZIONE DELLA TENUTA DEI FERMI OTTIMIZZANDO LA CHIUSURA A SECONDA DEL PESO DELLE ANTE. LA REGOLAZIONE AVVIENE AGENDO SULLA VITE TESTA CILINDRICA CON IMPRONTA ESAGONALE PRESENTE NEL FERMO.

THE SYSTEM ALLOWS PROPERLY ADJUSTING THE STOPPERS THUS OPTIMIZING DOOR CLOSING DEPENDING ON THEIR WEIGHT. ADJUST THE HEXAGON SOCKET SCREW FITTED TO THE STOPPER.

0187 Fermo superiore regolabile
Adjustable upper stopper

ART. 0195
ART. 0196

ART. 0138
ART. 0134

①

ART. 0251

ART. 0106

ART.0187

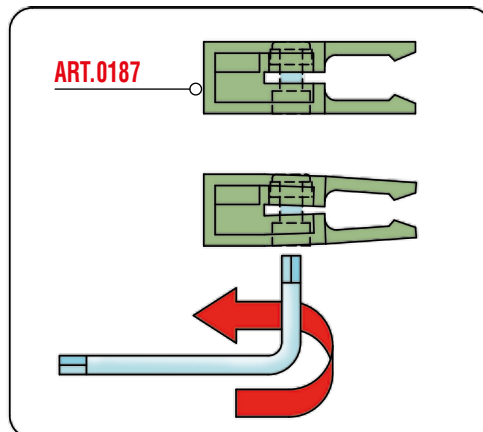

Inserire il carrello ed il fermo superiore nel relativo binario guida, assemblare il carrello alla staffa di tenuta premontata sulla porta e regolarne successivamente la verticalità tramite l'apposita chiave (1).

Insert the truck and the upper lock in their slideway, assemble the truck to the preassembled sealing bracket of the door, and then adjust the verticality of the door thanks to the special key (1).

0195	Profilo alluminio superiore Upper aluminium profile
0196	Profilo alluminio superiore Upper aluminium profile
0134	Carrello con 2 cuscinetti Truck with 2 ball-bearings
0138	Carrello con 4 cuscinetti Truck with 4 ball-bearings
0106	Guida inferiore Lower Guide
0251	Profilo alluminio inferiore Lower aluminium profile